

# PIAA

HIGH PERFORMANCE LIGHTING SYSTEMS

# 08



EUROPEAN CATALOG

# PIAA

HIGH PERFORMANCE LIGHTING SYSTEMS



## TABLE OF CONTENTS

- 05 // HALOGEN BULBS
- 07 // SPECIALTY MINIATURE BULBS
- 08 // HIGH INTENSITY LED VEHICLE SPECIFIC KITS
- 09 // LED FOR EUROPEAN CARS
- 11 // LED POSITION LIGHT BULBS
- 14 // H.I.D.
- 16 // PIAA SUPER SILICONE WIPERS
- 18 // PIAA ACCESSORIES



PIAA Corporation was established in 1963 with the commitment to manufacture world-class products that our customers could use with pride and confidence. Today, PIAA upholds that commitment by combining market driven concepts with the latest technology to make night and inclement weather driving as safe as possible.

### WHY BUY PIAA BULBS

**Greater Performance:** PIAA bulbs are engineered with XTRA Technology for greater performance per watt than any other bulb on the road. Greatly enhances your ability to see and be seen.

**Brilliant Color:** Beam color affects visibility and eye strain over long periods. The brilliant white/blue light allows comfortable night driving over extended periods of time. PIAA bulbs are both a performance upgrade and an aesthetic enhancement. You will see the difference even in the daytime.

**Warranty and Support:** PIAA is so confident in the durability and reliability of our products that we offer a no questions asked, replacement of any bulb that fails within one year of purchase. PIAA bulbs are an investment in safety and peace of mind.

### SPECIFIC BULB DESIGN FEATURES

- Metal bond holds the heat-resistant glass tube securely to prevent cracks and leaks
- Welded focus ring and one-piece filament support assures proper positioning
- XTRA technology for greater output and performance (XTRA is a term coined by PIAA to designate a high-efficiency bulb that is designed to produce greater light output than its rated power consumption. i.e. 55W=85W of light output)
- 100% quality-control testing for peerless performance



PIAA Corporation has been designing and manufacturing high performance bulbs for nearly a half-century. Quality begins with the design. PIAA scientifically engineers bulbs to exacting specifications utilizing the latest in integrated computer aided technology. Only the highest-grade materials are selected for use in products and every PIAA bulb is 100% tested at each step in the manufacturing process. PIAA is proud to offer you a wide range of bulbs you can use with pride and confidence!

### KELVIN SCALE



- 6600K // PIAA Super Cobalt H.I.D.
- 6200K // PIAA Cobalt Super H.I.D.
- 5250K // Sunlight
- 5000K // PIAA PIXER Plus H.I.D.
- 4700K // PIAA Xtreme Force
- 4300K // PIAA Super White & White
- 4150K // PIAA Xtreme White
- 4100K // PIAA Chrome Mirror White
- 4000K // PIAA Xtreme White Plus
- 
- 
- 
- 3200K // Halogen Bulb
- 
- 2600K // Incandescent Bulb



- Blue light source enhances crystal clear blue beam
- Closely resembles bluish-white color of H.I.I.D.
- Rated at 4700 Kelvin

## XTREME FORCE

PN	TYPE	WATTAGE	JANCODE-UPCCODE
H-247	H4	12v -60/55w=130/120w	4960311-236481
H-258	H3	12v -55w=110w	4960311-236511
H-257	H1	12v -55w=110w	4960311-236504
H-260	H7	12v -55w=110w	4960311-236634
H-259	HB3/4	12v -55w=110w	4960311-236627
H-318	H11	12v -55w=110w	4960311-237396
H-349	H9	12v -65w=120w	4960311-237686
H-320	T10	12v -5w wedge	4960311-237764



- PIAA's original upgrade bulb series
- XTRA watt technology with Xtreme cool blue white light provides superior performance
- Rated at 4150 Kelvin

## XTREME WHITE

PN	TYPE	WATTAGE	JANCODE-UPCCODE
H-208	H4	12v -60/55w=135/125w	4960311-235422
H-212	H3	12v -55w=110w	4960311-235910
H-214	H1	12v -55w=110w	4960311-235934
H-216	HB3/4	12v -55w=110w	4960311-235958
H-218	H7	12v -55w=110w	4960311-235972
H-317	H11	12v -55w=110w	4960311-237389
H-348	H9	12v -65w=120w	4960311-237679
H-222	T10	12v -5w wedge	4960311-236016



- PIAA's best-selling technology
- E-MARK, complies with European regulations Homologaton ECE R37
- XTRA watt technology with brilliant Xtreme cool white light provides superior performance
- Rated at 4000 Kelvin

## XTREME WHITE PLUS

PN	TYPE	WATTAGE	JANCODE-UPCCODE
HE-303	H4*	12v 60/55w=135/125w	4960311-237488
HE-305	H3*	12v 55w=110w	4960311-237495
HE-307	H1*	12v 55w=110w	4960311-237501
HE-309	H7*	12v 55w=110w	4960311-237518
H-251E	HB3**	12v 60w=120w	722935-196152
H-253E	HB4**	12v 51w=115w	722935-196169
H-354E	H11**	12v 55w=110w	722935-152110

\*E-MARK \*\*DOT

# // HALOGEN BULBS



## PLATINUM WHITE

- Platinum White Technology with XTRA watt technology emits pure-white color light economically priced
- E-MARK, complies with European regulations Homologation ECE R37
- Rated at 3800 Kelvin

### PLATINUM WHITE

PN	TYPE	WATTAGE	JANCODE-UPCCODE
HE-268	H4	12v -60/55w=110/100w	4960311-236689
HE-271	H3	12v -55w=85w	4960311-236696
HE-273	H1	12v -55w=100w	4960311-236702
HE-275	H7	12v -55w=100w	4960311-236719



## SUPER WHITE & WHITE

- PIAA's new whitest color bulbs produce a radiant white beam
- Radiant white beam without any tint of blue and featuring a new white top coat
- Rated at 4300 Kelvin

### SUPER WHITE & WHITE

PN	TYPE	WATTAGE	JANCODE-UPCCODE
H-353	H4	12v -60/55w=135/125w	4960311-237785
H-379	H3	12v -55w=110w	4960311-237891
H-380	H1	12v -55w=110w	4960311-237907
H-381	H7	12v -55w=110w	4960311-237914
H-382	HB3/4	12v -55w=110w	4960311-237921
H-474	H11	12v -55w=110w	4960311-293446
H-386	T10	12v -5w wedge	4960311-238072



## CHROME MIRROR WHITE

- Another innovation in bulb technology from PIAA
- The Chrome Mirror White range provides a new dimension in automotive lighting - by night, the Chrome Mirror generates a crisp, clean, intense white light and by day, the bulb is translucent and seems to disappear
- Rated at 4100 Kelvin

### CHROME MIRROR WHITE

PN	TYPE	WATTAGE	JANCODE-UPCCODE
H-352E	H4	12v -60/55w=130/120w	4960311-238027
H-359E	H3	12v -55w=110w	4960311-238034
H-360E	H1	12v -55w=110w	4960311-238041
H-361E	H7	12v -55w=110w	4960311-238058
H-362E	HB3/4	12v -60w=120w	4960311-238065
H-363	T10	12v -5w wedge	4960311-238713

# SPECIALTY MINIATURE BULBS //



- Miniature incandescent Xtreme White bulbs
- Match these bulbs to both headlight and other accessory lights for a sleek, unified appearance
- Suitable for a wide range of applications; can be used for side lamps, break lights, indicators, marker and interior lamps

## XTREME WHITE

PN	TYPE	WATTAGE	JANCODE-UPCODE
H-223	T10x31	12v - 10w Dome Light	4960311-236023
H-311	G14	12v - 8w	4960311-237280
H-224	T16	12v - 18w	4960311-236030
H-225	T20 Single	12v - 27w (Applicable 21w~27w)	4960311-236047
H-226	T20 Double	12v - 27/8w (Applicable 21/5w~27/8w)	4960311-236054
H-227	S25 Single	12v - 27w (Applicable 21w~35w)	4960311-236061
H-228	S25 Double	12v 27/8w (Applicable 21/5w, 27/8w, 35/5w)	4960311-236078



## MIRROR ORANGE

- Increasing the “cool-factor” of clear indicator lamp lenses are PIAA’s innovative Mirror Orange incandescent bulbs
- When installed in your clear lenses, the bulbs are nearly invisible but when illuminated provide a street legal, bright and conspicuous orange flash

## MIRROR ORANGE

PN	TYPE	WATTAGE	JANCODE-UPCODE
H-346	T20 Single	12v - 21w	4960311-237693
H-347	S25 Single	12v - 21w	4960311-237709

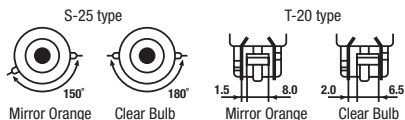

**CAUTION:** The shape of the base of the Mirror Orange is slightly different from normal clear S-25, T-20 type bulbs. Application is different from PIAA's Xtreme White Incandescent bulbs such as H-225 and H-227.



## MIRROR WHITE

- Miniature incandescent Mirror White bulbs
- Match these bulbs to both headlight and other accessory lights for a sleek, unified appearance
- When installed in your clear lenses, the bulbs are nearly invisible but when illuminated provide a clean, intense white light

## MIRROR WHITE

PN	TYPE	WATTAGE	JANCODE-UPCODE
H-364	T16	12v - 18w	4960311-238836
H-365	T20 Single	12v - 27w (Applicable 21w~27w)	4960311-238720
H-366	T20 Double	12v - 27/8w (Applicable 21/5w~27/8w)	4960311-238737
H-367	S25 Single	12v - 27w (Applicable 21w~35w)	4960311-238843
H-368	S25 Double	12v - 27/8w (Applicable 21/5w, 27/8w, 35/5w)	4960311-238850

# // HIGH INTENSITY LED VEHICLE SPECIFIC KITS

PIAA LED RING BULB



NORMAL



**FLASH CONTROL MODULATOR FOR 5 SERIES (E39)**  
 A resistor unit specifically designed to prevent abnormal light (flashing) of the PIAA LED Ring Bulb (H-500E) when mounted on the BMW 5 Series (E39)



for **5 series**



for **3 series**

- This bulb and socket assembly replaces the stock unit to give the vehicle's headlamp ring a clean, white 6500 Kelvin brilliance
- The upgrade changes the ring color from an incandescent yellow to brilliant H.I.D., matching the factory H.I.D. headlamps

## // APPLICATIONS //

// BMW LED RING BULB FOR 5 SERIES (E39 / E60), X5 (E53), 6 Series (E63), 1 Series (E87) and 7 Series (E65) //

// FLASH CONTROL MODULATOR FOR 5 SERIES (E39) //

// BMW LED RING BULB FOR 3 SERIES (E90) //

## BMW LED RING BULB

PN	TYPE	JANCODE-UPPCODE	PN	TYPE	JANCODE-UPPCODE
H-500E	For BMW 5 Series	722935-194318	H-432E	For BMW 3 Series	722935-194325
PH157E	FCM Unit for 5 Series (E39)	722935-191577			



# LED FOR EUROPEAN CARS //



- PIAA has incorporated a revolutionary calibrated resistor into our Super TERA LED for Mini Coopers
- By incorporating the calibrated resistor, the PIAA Super TERA LED becomes invisible to the Mini's highly sensitive On Board Computer System, thus preventing the activation of warning indicators
- Operates at an eye pleasing 6500 Kelvin

## SUPER TERA LED FOR MINI

PN	TYPE	JANCODE-UPCCODE
H-470	For MINI - R50/51	4960311-239512



NORMAL



// APPLICATIONS // BMW 1 SERIES (E87),  
3 SERIES (E90) AND 5 SERIES (E60) //

- PIAA has incorporated a revolutionary calibrated resistor into our Super TERA LED for room and map lamps of European vehicles
- Increase intensity of room light, while reducing electrical power consumption
- Operates at an eye pleasing 6500 Kelvin

## BMW ROOM LAMP

PN	TYPE	JANCODE-UPCCODE
H-490E	Plate Type Room Lamp Bulb	722935-194905



NORMAL



// APPLICATIONS // BMW 1 Series (E87),  
3 Series (E90), 5 Series (E60) and VW Golf V //

- PIAA has incorporated a revolutionary calibrated resistor into our Super TERA LED for room and map lamps of European vehicles
- Increase intensity of room light, while reducing electrical power consumption
- Operates at an eye pleasing 6500 Kelvin

## MAP LAMP

PN	TYPE	JANCODE-UPCCODE
H-491E	Wedge Type LED Bulb for Map Lamp	722935-194912

# // LED FOR EUROPEAN CARS



Whether you're coming or going your car makes a statement. PIAA's new LED License Plate Lamp Kit transforms your good-looking car into a GREAT-looking car — FROM ORDINARY TO EXTRAORDINARY!!

- Installs in just minutes
- Will not interfere with your vehicle's electrical system

- PIAA has incorporated a revolutionary calibrated resistor into our Super TERA LED Dome Bulb for European vehicles
- Increase intensity of room light, while reducing electrical power consumption
- Chrome finish housing with reflectors enhance brightness of high power LED

## LED LICENSE PLATE LAMP KIT

PN	TYPE	JANCODE-UPCCODE
X7105	LED License Plate Lamp Kit: 2 x H-492E / 1 x PH158E	-

## DOMELAMP

PN	TYPE	JANCODE-UPCCODE
H-492E	T10 x 37 LED Dome Bulb	722935-194929

# LED POSITION LIGHT BULBS //



- PIAA has incorporated a revolutionary calibrated resistor into our Super TERA LED Dome Bulb for European vehicles
- Increase intensity of room light, while reducing electrical power consumption
- Chrome finish housing with reflectors enhance brightness of high power LED

## DOMELAMP

PN	TYPE	JANCODE-UPCCODE
H-493E	T10 x 41 LED Dome Bulb	722935-194936



- PIAA has incorporated a revolutionary adjustable resistor into our HYPER TERA LED for position light on major European vehicles
- By incorporating the adjustable resistor PIAA HYPER TERA LED becomes invisible to the highly sensitive On Board Computer System on major European vehicles, thus preventing the activation of warning indicators
- This adjustable resistor can also prevent abnormal light of the HYPER TERA LED on certain vehicles
- Operates at an eye pleasing 6500 Kelvin

// APPLICATIONS //

// Mercedes-Benz C Class (W203), Audi A4, VW Golf V and Peugeot 407 //

For Application Updates Visit [PIAA.COM](http://PIAA.COM)

## HYPER TERA LED

PN	TYPE	JANCODE-UPCCODE
H-471	Wedge Type LED Bulb with Adjustable Resistor Unit	4960311-239529

# // LED POSITION LIGHT BULBS



## 超 TERA SUPER 6500K

- Newly designed 45 degree angle mounted (3) Hyper LED units with multi-surface lens top provides much wider beam than conventional LED unit
- (3) Hyper LED units produces more than 18 times brighter beam than conventional LED unit
- Specifically designed cooling fins significantly increase bulb life
- Operates at an eye pleasing 6500 Kelvin

### SUPER TERA 6500K

PN	TYPE	JANCODE-UPCCODE
H-376	T10	4960311-238744
H-429	H6W	4960311-239017



## 超 TERA SUPER 4500K

- Newly designed 45 degree angle mounted (3) Hyper LED units with multi-surface lens top provides much wider beam than conventional LED unit
- (3) Hyper LED units produces more than 18 times brighter beam than conventional LED unit
- Specifically designed cooling fins significantly increase bulb life.
- Rated at 4500 Kelvin

### SUPER TERA 4500K

PN	TYPE	JANCODE-UPCCODE
H-458	T10	4960311-239949



## HYPER DIMPLE SUPER LED

- New 5mm $\varnothing$  high intensity LED unit produces 20% brighter beam than existing model (Dimple Super LED)
- Brilliant designed multi-surface lens produces wide beam pattern and great look

### HYPER DIMPLE SUPER

PN	TYPE	JANCODE-UPCCODE
H-407	T10 - 1 LED 5mm $\varnothing$	4960311-238621

# LED POSITION LIGHT BULBS //



## 超 SUPER LED

- 6 micro LED units emit much wider beam pattern than conventional LEDs
- More colors to choose from - blue, white and clear white

### SUPER LED

PN	TYPE	JANCODE-UPCCODE
H-324	T10 - 6 Element (Blue)	4960311-237327
H-325	T10 - 6 Element (White)	4960311-237334
H-328	T10 - 6 Element (Clear white)	4960311-237372



## DIMPLE SUPER LED

- Plastic top lens provides wider beam than conventional LED unit
- Economically priced product

### DIMPLE SUPER LED

PN	TYPE	JANCODE-UPCCODE
H-326	T10 - 1 Element (Blue)	4960311-237341
H-327	T10 - 1 Element (White)	4960311-237358



## SUPER LED

- PIAA's original LED wedge bulb series
- Low electrical power consumption
- Extremely longer life

### SUPER LED WEDGE BULB

PN	TYPE	JANCODE-UPCCODE
H-261E	T10 - 2 Element (White / White)	722935-192611
H-262E	T10 - 2 Element (White / Blue)	722935-192628
H-263E	T10 - 2 Element (Blue / Blue)	722935-192635

// H.I.D.

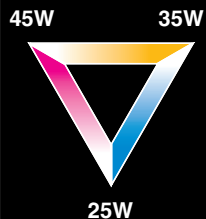

**TS**  
Three Stage



45W ⇄ 35W ⇄ 25W

When driving at high speeds requiring maximum visibility switch to 45w High Power Mode. 45w high power mode increases light output by as much as 30% over normal 35w mode and operates at 6000K.



Switching to 35w Normal Mode provides the best combination of safety (three times brighter than normal halogen) and performance (6600K).



25w Cool Mode is best suited for driving around town when being seen and looking cool (9200K) is your main goal.



PIAA's NEW TS (Three Stage) Technology allows the driver to control light output for optimum safety and performance in a multitude of driving conditions. With PIAA's TS Technology, you can choose to operate your headlamps at 25w, 35w or 45w mode.

PIAA's TS Technology is another example of our commitment of combining market driven concepts with the latest technology to make night and inclement driving as safe as possible.



CONVERSION KIT

**THREE STAGE SYSTEM - WITH SUPER COBALT 6600K H.I.D. CONVERSION KIT**

PN	TYPE	JANCODE-UPCODE	PN	TYPE	JANCODE-UPCODE
HH141TE	H4 Type - 12v 35w=170w (High / Lo)	4960311-270539	HH144TE	HB3/4 Type - 12v 35w=170w	4960311-270553
HH143TE	H7 Type - 12v 35w=170w	4960311-270546	HH145TE	H1 Type - 12v 35w=170w	4960311-270560

All complete kits include 2 x H.I.D. bulbs, 2 x ballast units (igniter and controller)

## CONVERT A NORMAL HALOGEN SYSTEM INTO A H.I.D. SYSTEM



- If performance is what you are looking for, this bulb is it
- Great performance without sacrificing PIAA's classic blue color
- Precise beam pattern for optimum performance
- Rated 6200 Kelvin
- Complete kit includes: two H.I.D. bulbs, two ballast units and wiring harness with relay

### 6200K COBALT SUPER H.I.D.

PN	TYPE	JANCODE-UPCCODE
HH111E	H4 Type - 12v 35w=170w (High / Lo)	4960311-244691
HH113E	H7 Type - 12v 35w=170w	4960311-244714
HH114E	HB3/4 Type - 12v 35w=170w	4960311-244721
HH115E	H1 Type - 12v 35w=170w	4960311-244738

## ENSURE YOUR COMPLETE SATISFACTION



- Upgrade factory H.I.D. to 6200 Kelvin
- Clean, clear crisp beam
- Rated 6200 Kelvin

### 6200K H.I.D. UPGRADE BULB

PN	TYPE	JANCODE-UPCCODE
HH15E	D1S - 12v 35w=170w	722935-199955
HH106	D2R - 12v 35w=170w	4960311-244448
HH107	D2S - 12v 35w=170w	4960311-244455

// H.I.D.



- PIAA's new PIXER Plus H.I.D. emits sharp, crisp powerful white beam
- Represents PIAA's best value H.I.D. conversion kit
- Newly designed short length burner allows for wider range of applications
- Rated 5000 Kelvin
- H.I.D. bulb with relay harness kit and ballast units each sold separately

### 5000K H.I.D. CONVERSION BULB KIT

PN	TYPE	JANCODE-UPCODE
HH171E	H4 Type - 12v 35w=170w (High / Lo)	4960311-293590
HH173SE	H7 Type - 12v 35w=170w	4960311-293606
HH174SE	HB3/4 Type - 12v 35w=170w	4960311-293613
HH175SE	H1 Type - 12v 35w=170w	4960311-293620
HH178SE	H11 Type - 12v 35w=170w	4960311-293637
HH179SE	H3 Type - 12v 35w=170w	4960311-293644
HH49	35w Ballast Kit ( 2 x Igniters & 2 x Controllers)	4960311-244196



- Both pin and hook style applications available (for LHD vehicle only)
- Activated silicone-coating action
- Revolutionary beading action
- Highest quality silicone rubber compound



### SUPER SILICONE

PN (LHD)	PN (RHD)	LENGTH	COLOR	JANCODE-UPCODE
WSP30EB	WS30EB	300 mm / 12"	Black	722935-950303
WSP33EB	-	330 mm / 13"	Black	722935-950334
WSP35EB	WS35EB	350 mm / 14"	Black	722935-950358
WSP38EB	WS38EB	380 mm / 15"	Black	722935-950389
WSP40EB	WS40EB	400 mm / 16"	Black	722935-395402
WSP43EB	WS43EB	430 mm / 17"	Black	722935-950433
WSP45EB	WS45EB	450 mm / 18"	Black	722935-950457
WSP48EB	WS48EB	475 mm / 19"	Black	722935-950488
WSP50EB	WS50EB	500 mm / 20"	Black	722935-950501
WSP53EB	WS53EB	525 mm / 21"	Black	722935-950532
WSP55EB	WS55EB	550 mm / 22"	Black	722935-950556
WSP60EB	WS60EB	600 mm / 24"	Black	722935-950600
WSP65EB	WS65EB	650 mm / 26"	Black	722935-950655
WSP70EB	WS70EB	700 mm / 28"	Black	722935-930701



Wiping action makes windshield water repellent



# PIAA SUPER SILICONE WIPER BLADES //



- Same frame and blade technology as the super silicone wipers
- Aerodynamic spoiler to reduce lift at high driving speeds
- Spoiler keeps the blade on the windshield



## SUPER SPORZA SILICONE

PN	LENGTH	COLOR		JANCODE-UPCCODE
WS45EFB	450 mm / 18"	Black		722935-933450
WS48EFB	475 mm / 19"	Black		722935-933481
WS50EFB	500 mm / 20"	Black		722935-399504
WS53EFB	525 mm / 21"	Black		722935-933535
WS55EFB	550 mm / 22"	Black		722935-933559
WS60EFB	600 mm / 24"	Black		722935-933603
WS65EFB	650 mm / 26"	Black		722935-933658



- Specifically engineered to fit aerodynamic windshields
- Activated silicone-coating action
- Revolutionary beading action
- Highest quality silicone rubber compound



## SUPER SILICONE CURVED WIPER

PN	LENGTH	COLOR	JANCODE-UPCCODE
WS45CEB	450 mm / 18"	Black	722935-932453
WS48CEB	475 mm / 19"	Black	722935-932484
WS50CEB	500 mm / 20"	Black	722935-932507
WS53CEB	525 mm / 21"	Black	722935-932538
WS55CEB	550 mm / 22"	Black	722935-932552

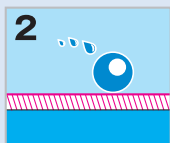

Rain beads up

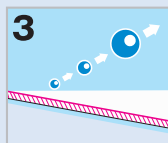

Rain repels easily by wind pressure (in high speed) or by ordinary wiping (in low speed)

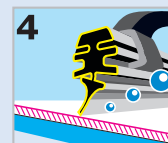

Super-smooth glide, no squeaking (elimination of annoying and inefficient chattering)

# // PIAA ACCESSORIES



- Attention getting
- Powerful 115db dual tone
- Weather resistant cover
- Easy installation
- Super-light weight

## SPORTS HORN

PN	MODEL	JANCODE-UPCODE
HO-2E	400 Hz + 500 Hz	722935-851105
HO-8E	500 Hz + 600 Hz	722935-851129



- Increases bulb life by as much as 40%
- Maintains constant 13.2 Volts for ultimate bulb performance
- Improved bulb performance
- Easy installation

## DC/DC CONVERTER

PN	MODEL	JANCODE-UPCODE
LR-27E	For H4 style - Dual Filament Bulb	722935-952003
LR-28E	For Single Filament Bulb (Bullet-Style Connector)	722935-852058



## BULB CABINET DISPLAY

- Cabinet style display with a clear lexan locking door and three interior shelves
- Holds 36 twin pack bulbs (bulbs not included)
- Designed to sit on the counter or a shelf
- No assembly required
- Measures: 450mm(W) x 550mm(H) x 215mm(D)



## LED BULB WORKING DISPLAY

- Designed to show 6 different types of PIAA's LED wedge bulbs or dome light bulbs
- No assembly required
- Measures: 400mm(W) x 130mm(H) x 160mm(D)



## XTREME WHITE PLUS TRAY TYPE DISPLAY

- Holds 8 twin pack bulbs (bulbs not included)
- Specifically designed header card for Xtreme White Plus



## COUNTER BULB DISPLAY

- Swivel display with clear acrylic locking doors on both sides
- Holds 12 twin pack bulbs - 3 shelves on both sides (bulbs not included)
- Some assembly required
- Measures: 300mm(W) x 480mm(H) x 220mm(D)



## XTREME WHITE PLUS WORKING DISPLAY

- Designed to show comparison of normal bulb and Xtreme White Plus
- Power supply not included
- Measures: 280mm(W) x 365mm(H) x 135mm(D)



## PIAA BANNER

- Large size weather resistant vinyl PIAA banner
- Measures: 240mm(H) x 480mm(W)

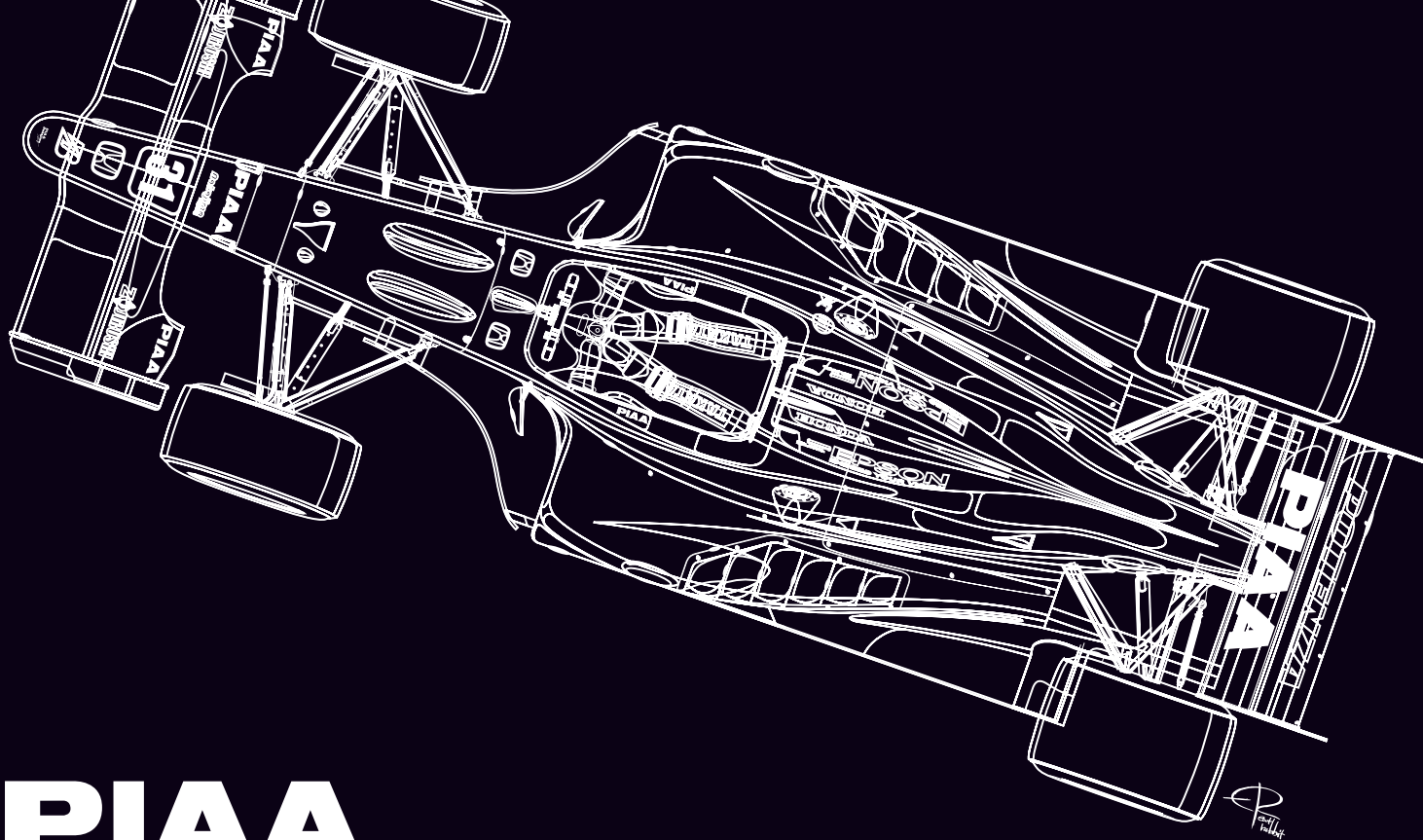

# PIAA

**PIAA CORPORATION**

Aoyama OVAL Bldg. 5-52-2 Jingumae, Shibuya-ku, Tokyo 150-0001 Japan  
[www.piaa.com](http://www.piaa.com)